



SILVERLINE

2020 SERIES



LUXURY
AS STANDARD.



ALL NEW 2020 JAYCO SILVERLINE.

Welcome to Jayco's 2020 range; in our 45th year innovation still remains at the forefront of the seven product ranges Jayco offers you, with each range ready to take you off on your next adventure.

The epitome of luxury caravanning, the 2020 Silverline Series allows you to experience the pinnacle of sophistication and comfort with intuitive voice activation.

Equipped with voice-activated control, the Jayco 2020 Silverline Series caravans push the boundaries of mobile adventure. With just a few simple requests, your Silverline creates the perfect environment for travelling, entertaining or relaxing.

With Amazon Alexa control, the command: "Alexa, turn on my RV" will extend the awning, extend the slide out section and turn on your lights so you can ease into your holiday with minimal fuss.

The future of caravanning has arrived, the Jayco way.



Silverline Touring

Silverline Outback



MODERN LUXURY INTERIORS.

Aesthetic and performance come together in Jayco Silverline 2020's kitchen with new modern features that will bring out your inner chef including a 4-burner gas cooktop and rangehood, 216L fridge and microwave.



Distinct living zones ensure comfort and style is uncompromised. Sit back and relax on the genuine leather lounge at the end of your adventures.



The contemporary full ensuite exudes style, with sleek matte black sink and tapware throughout, ample storage and a built-in washing machine.



European design cabinetry featuring 'soft close' drawers with positive locking Italian hardware.

ALL NEW 2020 JAYCO SILVERLINE

Luxury features come standard in the Jayco Silverline. All you need to do is step in, relax and the rest is taken care of.

Silverline is a premium travel experience, with features customised to the way you choose to live and aimed to reflect the luxury of the modern home. Harrier air-conditioning, Cloud 9 Premium mattress, full en-suite with separate shower and toilet, and dinette seating in genuine designer leather puts the 2020 Silverline Series in a class of its own. A refined and tastefully understated kitchen is the heart of this home, blending perfect form and function. And a timeless aesthetic is complemented with a suite of features in this sleek and modern kitchen, that includes a 216L fridge, 4-burner gas cooktop and oven, an abundance of storage with soft touch close drawers.

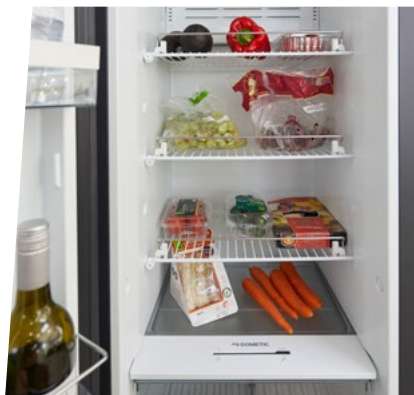

There's plenty of room for all the delicacies in the 216L fridge.



All new Nautilus hot water system – never run out of hot water again.







Clean and stylish pop-up tower to stay powered on your travels.



Significant design and mould changes allows for even greater capacity to store goods in the new the large front storage boot.

SILVERLINE CARAVAN FOORPLANS.

 Shower
  Refrigerator
  Wardrobe
  Sleeps standard
  Sleeps optional



19 FT SLIDE

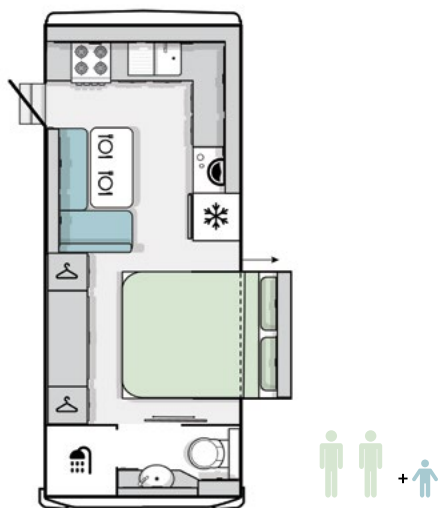

19.61-5 Tandem Axle	TOURING	OUTBACK
Tare Weight (approx)	2532 kg	2647 kg
Towball Weight (approx)	166 kg	157 kg
Body Length	6125 mm	6125 mm
Interior Height	1975 mm	1975 mm
Travel Height	2950 mm	3080 mm
Travel Length	7375 mm	7400 mm
Travel Width	2470 mm	2470 mm

20 FT DINETTE

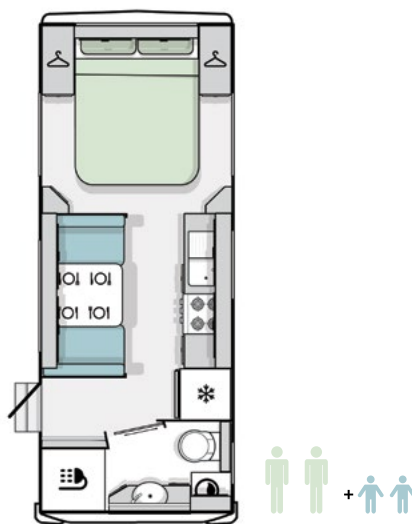

20.63-2 Tandem Axle	TOURING	OUTBACK
Tare Weight (approx)	2340kg	2650 kg
Towball Weight (approx)	154 kg	174 kg
Body Length	6521 mm	6560 mm
Interior Height	1975 mm	1975 mm
Travel Height	2950 mm	3080 mm
Travel Length	7892 mm	8065 mm
Travel Width	2470 mm	2470 mm

21 FT CLUB FRONT

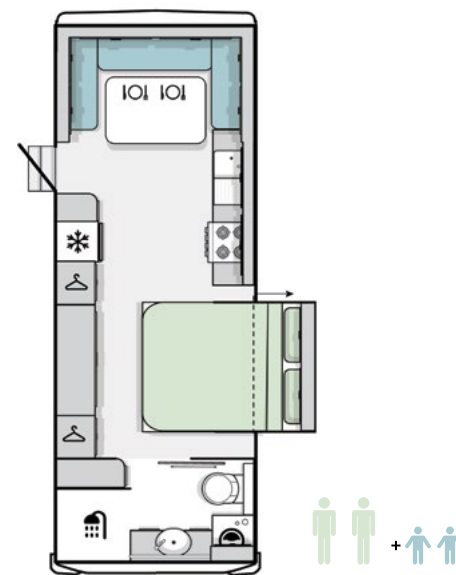

21.65-3 Tandem Axle	TOURING	OUTBACK
Tare Weight (approx)	2560 kg	2696 kg
Towball Weight (approx)	184 kg	174 kg
Body Length	6760 mm	6760 mm
Interior Height	1975 mm	1975 mm
Travel Height	2950 mm	3080 mm
Travel Length	8040 mm	8065 mm
Travel Width	2470 mm	2470 mm

The weights and dimensional data are not binding. Jayco reserve the right to alter specifications without notice. These are a guide only and will change depending on accessories fitted to your van. It is advised to discuss this with your Jayco representative. The load carrying capacity of Jayco RV's vary from product to product to ensure it is fit-for-purpose.



24 FT CLUB FRONT

24 FT CLUB SLIDE

21 FT SLIDE

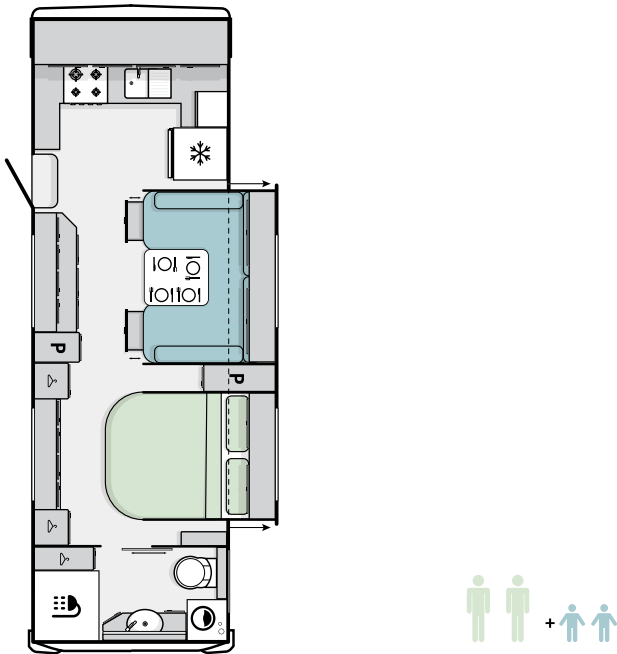
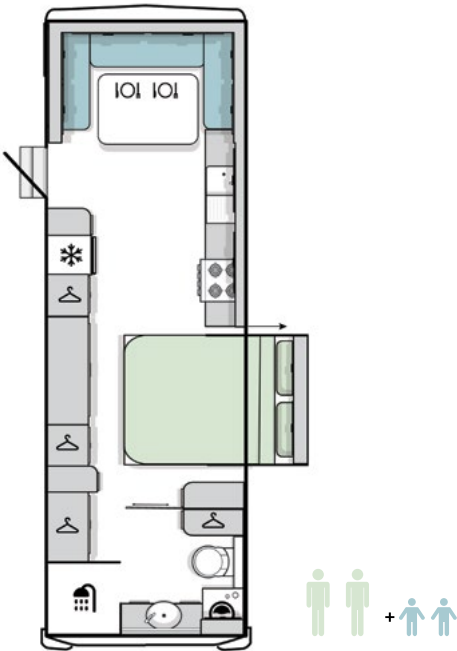
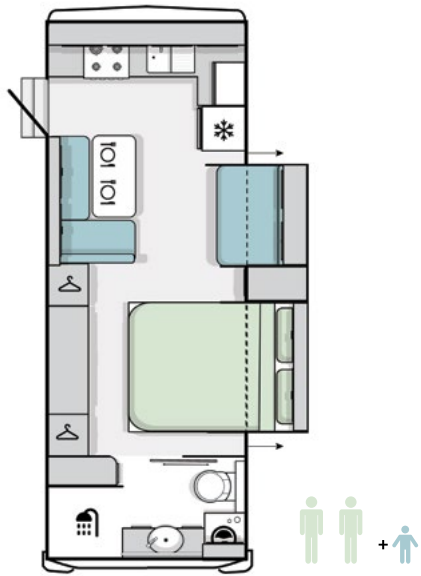

21.65-4 Tandem Axle	TOURING	OUTBACK
Tare Weight (approx)	2571 kg	2727 kg
Towball Weight (approx)	174 kg	156 kg
Body Length	6760 mm	6760 mm
Interior Height	1975 mm	1975 mm
Travel Height	2950 mm	3080 mm
Travel Length	8040 mm	8065 mm
Travel Width	2470 mm	2470 mm

24.75-2 Tandem Axle	TOURING	OUTBACK
Tare Weight (approx)	2691 kg	2832 kg
Towball Weight (approx)	213 kg	215 kg
Body Length	7520 mm	7520 mm
Interior Height	1975 mm	1975 mm
Travel Height	2950 mm	3080 mm
Travel Length	8795 mm	8820 mm
Travel Width	2470 mm	2470 mm

24.75-4 Tandem Axle	TOURING	OUTBACK
Tare Weight (approx)	2740 kg	2885 kg
Towball Weight (approx)	220 kg	230 kg
Body Length	7520 mm	7520 mm
Interior Height	1975 mm	1975 mm
Travel Height	2950 mm	3080 mm
Travel Length	8795 mm	8795 mm
Travel Width	2470 mm	2470 mm

SILVERLINE CARAVAN FEATURES.

• Standard ✕ Optional - Not Available ^ Model Specific



Enjoy the outdoors with an electric awning as standard.

	TOURING	OUTBACK
CONSTRUCTION		
Chassis - Hot dipped galvanised	•	•
Furniture - Euro style with aluminium corners & seat framing	•	•
Roof - sandwich construction, one piece fibreglass skin	•	•
Suspension - JTECH Suspension Independent Coil	•	•
Walls - fully insulated Toughframe, hail & dent resistant	•	•
SAFETY		
360 degree Cameras	•	•
Brake Unit - Tow Secure Emergency Braking	•	•
Electric Brakes	•	•
External Triple Lock security door	•	•
Lockable Water Filler	•	•
Sway Command Tow Control	•	•
STORAGE		
EziGlide Drawers including Pot Drawer	•	•
Front Entry Boot	•	•
Large Storage area under bed	•	•
Overhead storage compartment	•	•
Side Entry Boot	•	•
Slide out heavy duty storage drawer	✕	✕
TECHNOLOGY		
100 Ah Lithium Battery	✕	✕
Additional 100 Ah Lithium Battery	✕	✕
Additional roof mounted 150w Solar Panel	✕	✕
Satellite System	✕	✕
Additional 100 Ah Battery	✕	✕
Amazon Echo Dot smart speaker with Alexa Voice control	•	•
Roof mounted 150w Solar Panel with regulator	•	•

	TOURING	OUTBACK
TECHNOLOGY (continued)		
Roof mounted WiFi extender	•	•
Bluetooth enabled for battery and water tank monitoring app	•	•
Built in battery management system with built in 240v charger	•	•
100 Ah Battery	•	•
24" LED 12v TV with built in DVD player	•	•
CD/Radio with Internal & External Speakers	•	•
LED display for battery and water tank monitoring	•	•
Roof mounted TV antenna	•	•
Winegard Sensor Pro Signal Amplifier	•	•
INTERIOR FEATURES		
216L Fridge with separate freezer compartment	•	•
4 Burner Cooktop with built in Griller & Oven	•	•
Microwave	•	•
Double bed with orthopaedic slats	•	•
Gas Hot Water System - Continuous flow	•	•
Modern design shower with exhaust fan	•	•
Premium Cloud 9 pillowtop innerspring mattress	•	•
Purpose designed bed linen including doona and pillows	•	•
Pop up TV^	✕	✕
Rangehood with 12v LED light & twin fans	•	•
Roof mounted Air Conditioner	•	•
Seating area with selection of genuine leather	•	•
Seating area with selection of modern fabrics	✕	✕
Shurflo 12v Water pump	•	•
Truma Ducted Gas heating	✕	✕
Washing Machine with 3.3kg capacity	•	•
Water filtration system to sink	•	•

	TOURING	OUTBACK
EXTERIOR FEATURES		
12v Power outlet doorside	•	•
240v Power outlet doorside	•	•
12v Electric Awning with LED light	•	•
Alloys & Tyres - 195/R15 HT including spare	•	-
Alloys & Tyres - 245/70R16 AT including spare	-	•
Awning walls^	✕	✕
Corner steadies - Drop	•	•
Coupling - D0-35	-	✕
Picnic table	•	•
Extended A-Frame	✕	✕
External entertainment hatch including swivel TV bracket	•	•
External shower hatch with pop up tent	✕	•
Fresh Water tank - 2 x 80L	•	•
Grey Water tank^	✕	✕
Front and rear fibreglass smooth styling	•	•
Gas Bottles - 2 x 9kg	•	•
Jockey Wheel - Centre mount	•	•
Light - LED 12v grab handle	•	•
Mains pressure to A-Frame tap	•	•
Rear mounted bike rack^	✕	✕
Side checkerplate protection	-	•
Slide out external kitchen with cook top and sink	✕	✕
Slide out Step	•	•
Under mounted gas bayonet for external cooking	•	•

INNOVATION
MEETS LUXURY.



1 2
3 4



RV CONNECT

World's First Voice Activated Production RV

The new Jayco Silverline caravan redefines luxury in caravanning, and now, Silverline is also the world's most advanced caravan. The all-new technology suite RVConnect blurs the lines between home and away helping you seamlessly make the most of your leisure lifestyle.

Exclusive to Jayco and standard on our production 2020 Jayco Silverline Caravan, RVConnect is a collection of lifestyle technology that includes the following features:

- 1 Amazon Alexa: A personal voice assistant that allows you to voice command a number of basic tasks such as turning your caravans lights on and off, open awning & slide out, gaining access to weather forecasts and recipes.
- 2 360-degree cameras, there are no blind spots when towing and parking – a world first in a production RV.
- 3 Smartphone app-controlled electric awning with personal presets, operated within Bluetooth range.
- 4 Winegard and Wi-Fi extender that captures signals within a significantly increased range and provides mobile internet speed with 4G capability.

RVConnect sets a new benchmark in technology and luxury.

The image shows the interior of a modern caravan. A large, light-colored leather sofa is positioned in front of a wide window that looks out onto a vineyard. A small table is set up in front of the sofa with a bottle of wine, glasses, and a plate of food. To the right, there is a kitchen area with white cabinets and a countertop. A vase of orange flowers sits on the counter. The interior is well-lit with overhead lights and natural light from the windows.

THE FUTURE OF CARAVANNING.

The future of caravanning is here. Jayco 2020 Silverline Series seamlessly integrates technology for intuitive, effortless living in the world's smartest RV.

Luxury is at your fingertips from the moment you enter and, in a world first for production RVs, you will be able to fully configure your caravan with Amazon Alexa – your own personal virtual assistant.

By simply saying "Alexa, turn on my RV", you can set up your Silverline for holiday mode. The Silverline 2020 Series is caravan living at its finest. Connectivity is made possible with access to the Winegard 4G Wifi extender, a 240V power tower and JHUB control panel. Step in, sit back and let the Silverline luxury do the rest.



Outdoor entertaining is easy with the external slide-out kitchen. Easy to pull out and stow away after use with built in chopping board.



Watch your favourite TV shows and movies on the sleek pop up TV. ^

OPTIONAL EXTRAS

Complement the innovation showcased in Jayco's 2020 Silverline Series with a range of options to upgrade and create the ultimate RV living experience.

A suite of companion features can be integrated throughout the Jayco Silverline, including: external slide out kitchen for a seamless outdoor entertaining setting, an external slide out drawer to allow for even more storage, rear bike rack and even a Sphere Satellite Dish to maximise connectivity. The freedom to create your Silverline is only an option away.



Truma Gas Heating keeps the cabin warm while you enjoy adventures during the cooler months.



Sphere Satellite Dish keeps you connected to your favourite TV shows and live sport.



Maximise the adventure with a rear-wall bike rack, with space for 2 bikes. ^

CONSTRUCTION YOU CAN TRUST.



JAYCO TOUGH FRAME

Jayco's vacuum-bonded quad-layer wall construction technology is both stronger and lighter than the conventional 'timber & tin' aluminium-clad caravan walls. Built on lightweight aluminium frame for extra strength and longevity, the Jayco Tough Frame provides great thermal and acoustic insulation. The furniture in your Jayco caravan is built on our patented aluminium frame for strength and durability.

- 1 Hail and dent resistant, aerodynamic fibreglass exterior with high gloss finish.
- 2 External 3mm plywood board to increase structural strength.
- 3 Aluminium frame - not timber - for extra strength, plus galvanised plating for secure fitment of internal furniture.
- 4 Internal high-density polystyrene foam for superior insulation.
- 5 Internal 3mm plywood board polyester coated for maximum durability.



JTECH 2.0 SUSPENSION

The Jayco Silverline come with a precision manufactured suspension system (standard on Outback). The specially designed, high-performance JTECH 2.0 Suspension delivers greater stability, a smoother ride, exceptional handling and increased ground clearance.

Purpose-built to complement the Jayco Endurance chassis, JTECH independent coil suspension delivers greater stability, precise handling and increased ground clearance for easy and safe towing.

Each JTECH 2.0 Suspension system includes:

- Electro-coated surfaces for protection against corrosion and stone chips
- Stub axles, bearings and brakes that are suitable for fitment of Lippert Sway command technology
- Large diameter, heavy-duty Pedders off-road shock absorbers and coil springs designed specifically for Jayco RVs and Australian conditions
- Aeon rubber springs inside each coil spring, producing a progressive rate when the suspension is compressed
- Toe-in and toe-out adjustment for wheel alignment

ENDURANCE CHASSIS

An RV is only as strong as the base on which it's built, so we build our Endurance Chassis to last like no other. Lightweight yet super strong, it's hot dip galvanised for extra protection against corrosion, and features PSC member floor support, which better resist bending and compression, while also safeguarding under floor wiring and plumbing.

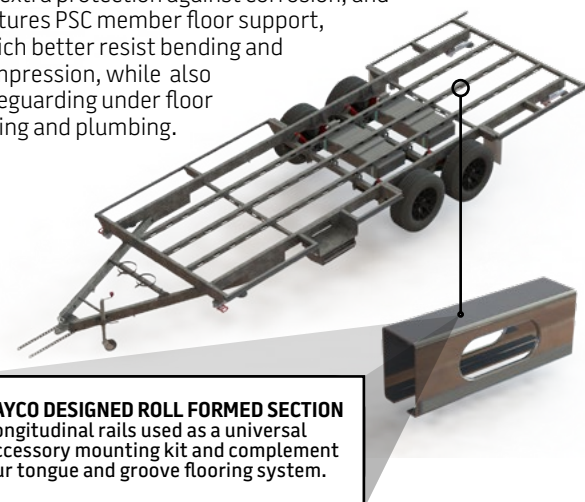

ALUMINIUM FRAME

The furniture in your Jayco Silverline is built on our patented aluminium frame for strength and durability.

DURABILITY & DESIGN.



OUTBACK UPGRADE

Even if the places you want to get to are a long way off the bitumen, there's no reason why you can't bring a little comfort with you. The Jayco Outback Silverline has higher ground clearance, a range of high-strength componentry and specialised features, including:

- JTECH 2.0 Independent Suspension
- 150 W solar panel and regulator
- 100 Amp Hour (A/H) Battery
- 150 mm x 50 mm rectangular hollow-section chassis members
- 125 mm x 50 mm rectangular hollow-section A-Frame
- Off-road electric brake magnets
- Outback drop jacks
- Protective aluminium checker plate on sides
- 16-inch alloy wheels & tyres
- Rear Fibreglass moulds[^]
- Pull-out single alloy step
- External 12 V auxiliary plug
- External gas bayonet
- Jayco mud flaps
- 8-inch jockey wheel

NOTE: A Jayco Outback upgrade allows towing on limited unsealed roads. Always take care to prepare for unsealed road usage by understanding the road conditions and the associated towing requirements. We also recommend reading your Jayco Owner's Handbook for more information about warranty terms and conditions.



UNRIVALLED COMFORT

Jayco continues to lead the way for Australian RV manufacturing and design and in 2020 the vision remains steadfast – maximise comfort through superior design, the Jayco way.

Uncompromised comfort is showcased throughout our 2020 ranges and is brought to life through innovative design and quality materials.

Jayco continues to innovate Australia's RV industry with an aspiration for Jayco RVs to stand the test of time. This includes style which incorporates design influences from Australia and Europe.

This is unrivalled comfort and superior design – the Jayco way.

SAFETY YOU CAN TRUST.

NITROGEN-FILLED TYRES

Nitrogen keeps your tyres as cool as possible and helps maintain a constant tyre pressure even in hotter weather, reducing the risk of blowouts.

Sway command® tow control technology

Safety first, with Lippert Sway Command® Tow Control Technology



- A** Critical swerve or sway is detected.
- B** Sway Command® Tow Control partially applies the RV brakes. The caravan is pulled into line behind the tow vehicle. The sway is stopped and the caravan brakes are released.

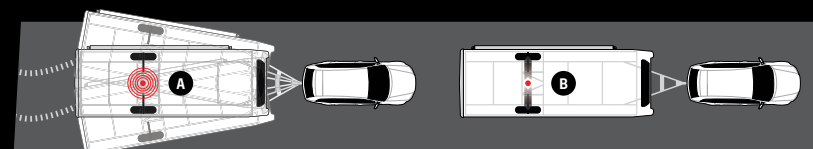

BREAKAWAY SYSTEM

If a caravan accidentally separates from the tow vehicle, the system will activate the electric brakes and brake lights (optional).

360-DEGREE CAMERA

New 360-degree cameras: there are no blind spots when towing and parking – a world-first in a caravan production.

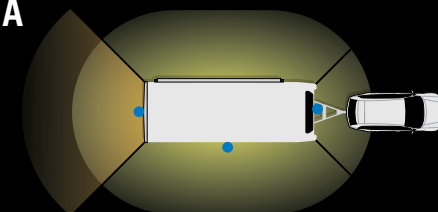

[^] Model specific

THE JAYCO DIFFERENCE.

Jayco is Australia's leading RV manufacturer and for 45 years has pioneered the RV and caravan industry in Australia, resulting in Jayco being one of the country's most recognised brands known for its innovation advancements in creating quality and affordable recreational vehicles.

AUSTRALIAN MADE

Designed and built by Australians, for Australians to take on the Australian terrain, all Jayco RVs proudly wear the Australian-made logo.

GREAT RESALE VALUE

Jayco RVs keep their value exceptionally well and are considered to be a long-term investment.

BETTER VALUE

As the largest Australian RV manufacturer, Jayco has a great buying power and passes the savings on to our customers, delivering more features for less.

LARGEST SUPPORT NETWORK

No matter where your adventure takes you, Jayco's extensive service network will be nearby to assist in the unlikely event a priority repair is required. With 126 National Jayco Service Agent Representatives located around Australia, the expertise or spare parts you need are never far away to help and is the most comprehensive RV service offering in Australia. Jayco's assist service is with you every step of the way. That's motorhoming, the Jayco way.

FINANCE THE DREAM

Financing your next adventure is easy and Jayco offers a number of finance options through Jayco Financial Services. This means we can provide a variety of loan options such as flexible loan terms from one to seven years, competitive finance deals, quick and easy approval, all supported by Jayco's exceptional customer service.

INSURANCE

Jayco Platinum Insurance provides competitive premiums and market leading cover that is available at all Jayco dealerships or can be accessed online providing an easy to use and quick quoting portal. Whether you take your caravan on short holidays or year long travels, we can tailor a policy to suit your caravanning needs.



Jayco Financial Services Pty Ltd Credit Representative number 513573 of My Local Broker PTY LTD (Australia Credit License no 481374) Finance will be supplied to approved applicants only (not available to fleet, government or rental buyers), subject to credit assessment and lending criteria. Fees and charges are payable. Full conditions available on application. All images are for illustration purposes only. Features subject to change.



ADVENTURE
AWAITS...





JAYCO.COM.AU | 1300 JAYCO RV

Jayco Corporation Pty Ltd owns the copyright in this brochure. Unauthorised use, reproduction or adaptation is forbidden and will be prosecuted. Due to ongoing improvement, the specifications in this brochure are subject to change without notice. ©JAYCO 2020 PO Box 636 Dandenong VIC Australia 3175.